

I'm home

and the empty house
seems bigger than usual
nobody to talk to
it would be more interesting
to have someone here
to argue with

there is a too quiet silence within
tall walls looming
above me
below
I'm hungry

Sylvia E. Fry

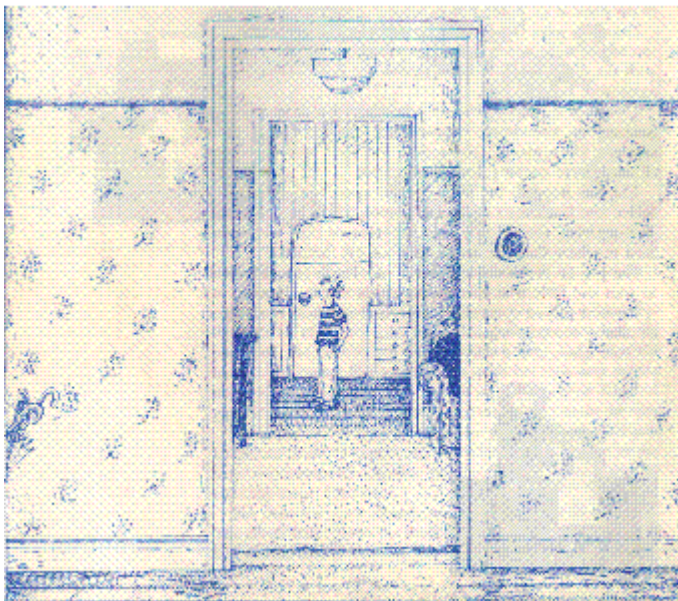

Source: School Journal, Part 4, No 2, Learning Media, 1983.

I'm home

This task is about making inferences from a poem.

Read the poem "I'm home" then answer the following questions.

- a) i) What time of day is the poem most likely about?

- ii) Write a reason to support your answer to i).

- b) What **three** words from the poem best describe the feeling of loneliness?

i) _____

ii) _____

iii) _____

- c) What does the poet mean when she says "...a too quiet silence"?

- d) What line in the poem makes the house seem alive?
