



Aman Organization  
[www.amanyemen.org](http://www.amanyemen.org)



Wikieducator Organization  
[www.wikieducator.org](http://www.wikieducator.org)

[www.wikieducator.org/user:Rima](http://www.wikieducator.org/user:Rima)

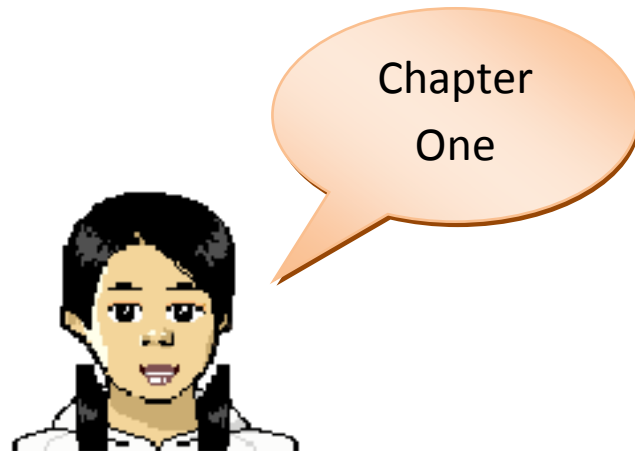



Aman Organization  
[www.amanyemen.org](http://www.amanyemen.org)



[www.wikieducator.org/user:Rima](http://www.wikieducator.org/user:Rima)

Wikieducator Organization  
[www.wikieducator.org](http://www.wikieducator.org)

## Paint and Draw Tools

To create your own pictures, shapes, or lines using computer you can use paint or drawing program.

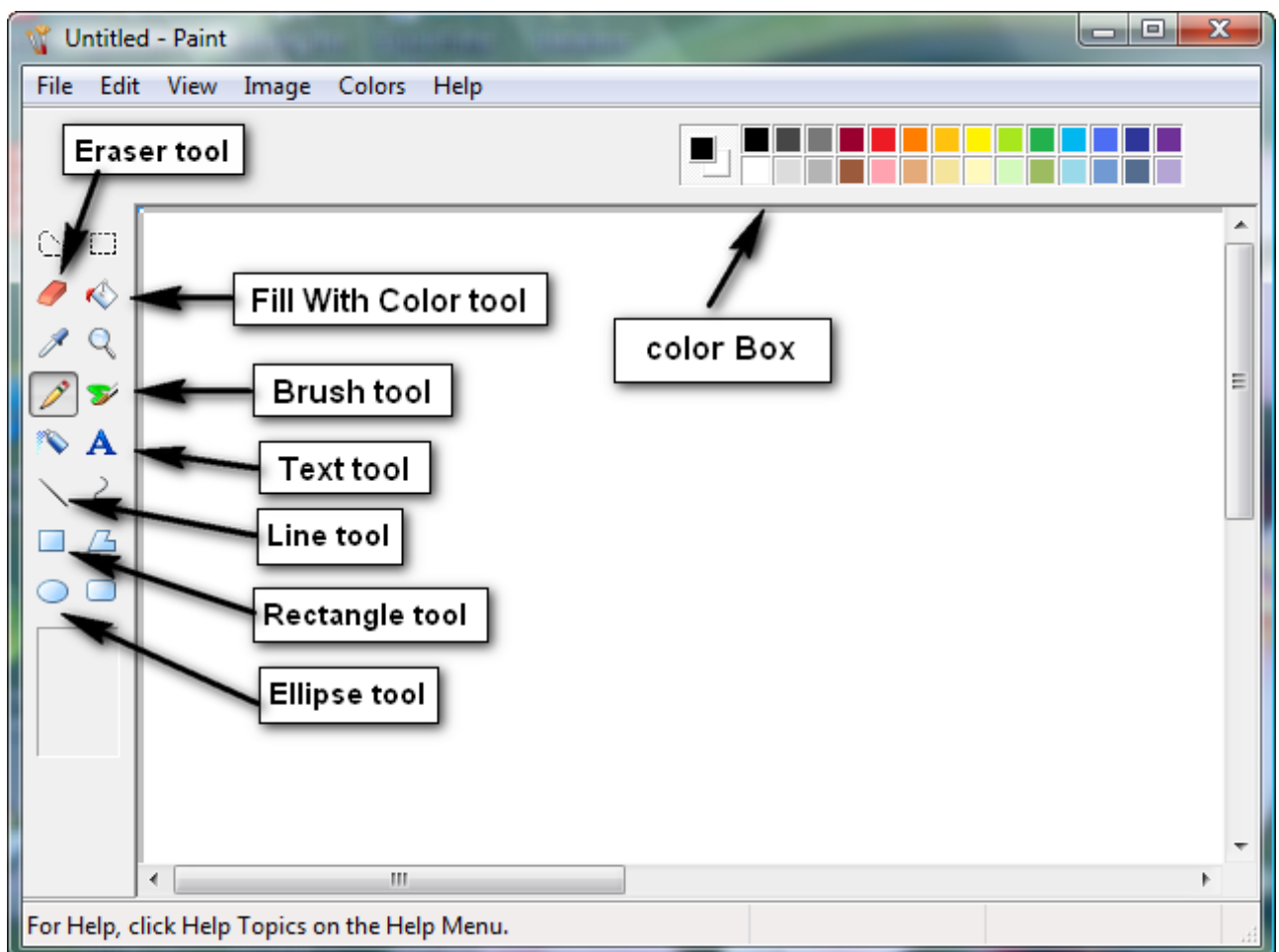



Aman Organization  
[www.amanyemen.org](http://www.amanyemen.org)

[www.wikieducator.org/user:Rima](http://www.wikieducator.org/user:Rima)



Wikieducator Organization  
[www.wikieducator.org](http://www.wikieducator.org)

**Drawing program has drawing tools in a toolbox.**

**These tools help you paint and draw using the computer.**

**You use the mouse to control the tools.**

- **Point**
- **Click**
- **Double-click**
- **Drag**
- **White space or **canvas** is the blank area on the screen that you use to draw.**

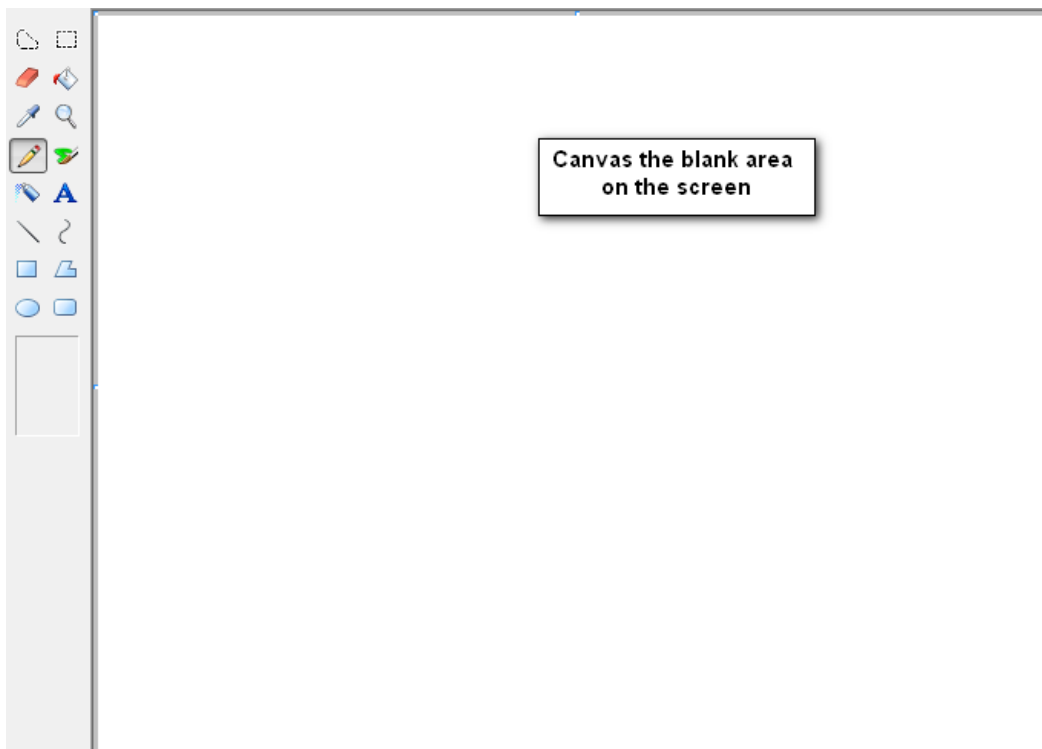



Aman Organization  
[www.amanyemen.org](http://www.amanyemen.org)



Wikieducator Organization  
[www.wikieducator.org](http://www.wikieducator.org)

[www.wikieducator.org/user:Rima](http://www.wikieducator.org/user:Rima)

## Start Paint

Start the paint or Draw program on your computer.



1. Click start.

2. Click All Programs.

3. Click Accessories.

4. Click Paint.

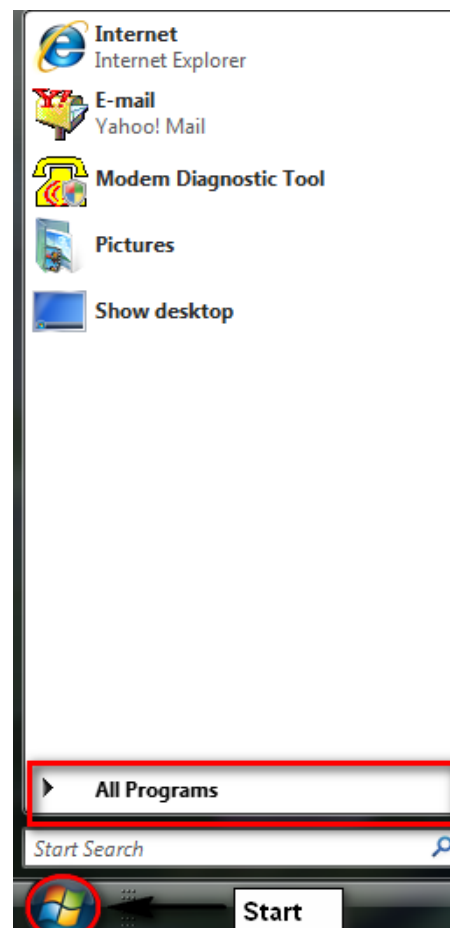
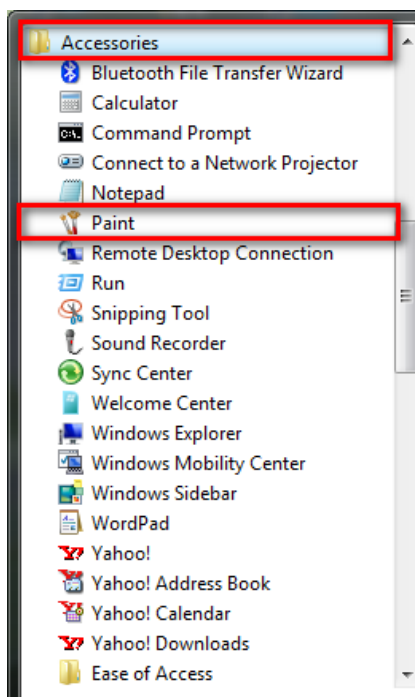



Aman Organization  
[www.amanyemen.org](http://www.amanyemen.org)



Wikieducator Organization  
[www.wikieducator.org](http://www.wikieducator.org)

[www.wikieducator.org/user:Rima](http://www.wikieducator.org/user:Rima)

## Using Color Box

**Drawing a rainbow:**

**1. Click the Brush tool in the toolbox.**



**2. Click a wide brush shape in the color box.**

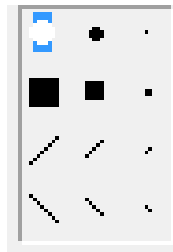

**3. Click the color red in the color box.**





Aman Organization  
[www.amanyemen.org](http://www.amanyemen.org)



[www.wikieducator.org/user:Rima](http://www.wikieducator.org/user:Rima)

Wikieducator Organization  
[www.wikieducator.org](http://www.wikieducator.org)

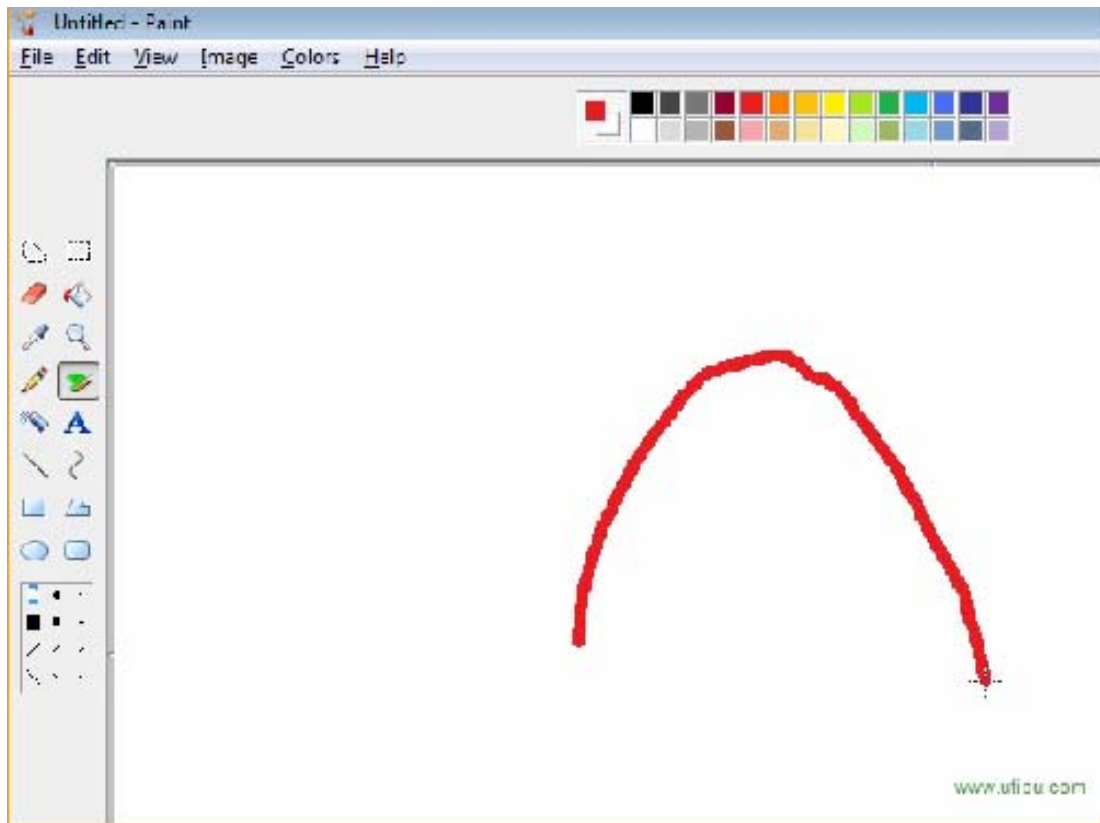

**4. Drag the Brush tool pointer to draw the red arch in the rainbow.**



Aman Organization  
[www.amanyemen.org](http://www.amanyemen.org)



[www.wikieducator.org/user:Rima](http://www.wikieducator.org/user:Rima)

Wikieducator Organization  
[www.wikieducator.org](http://www.wikieducator.org)

5. Click the color orange in the color box and then drag the Brush tool pointer to draw the orange arch below the red one.

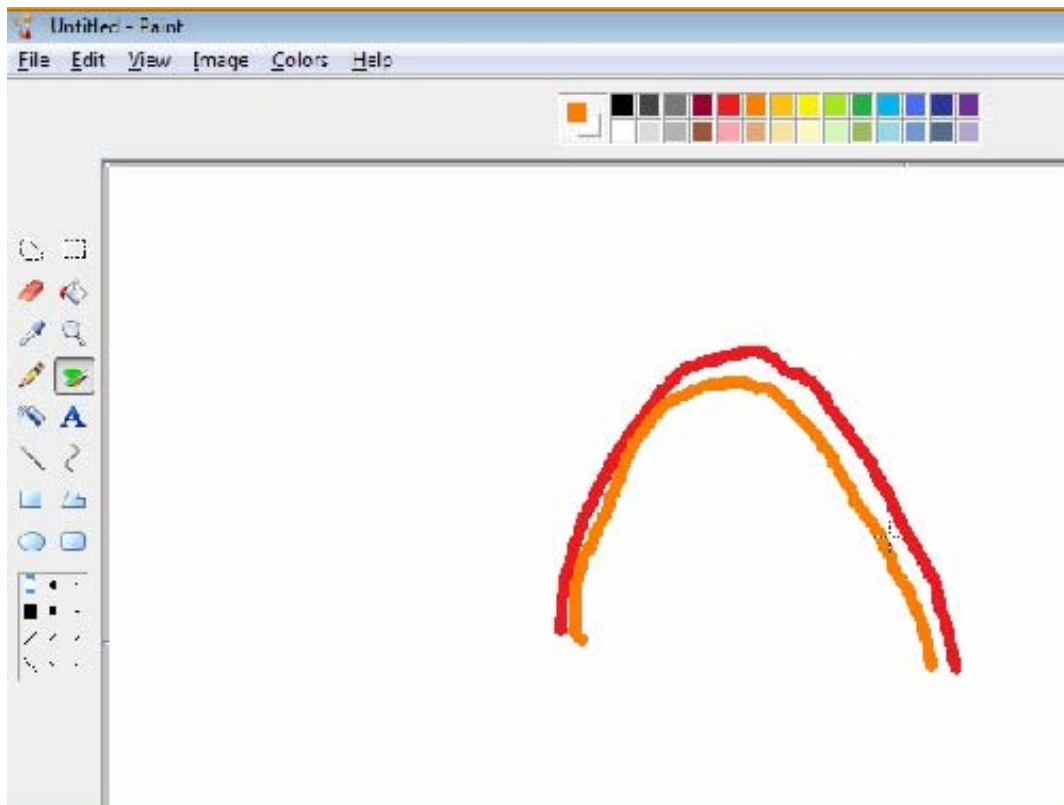

6. Draw the remaining colors of the rainbow.



Aman Organization  
[www.amanyemen.org](http://www.amanyemen.org)



Wikieducator Organization  
[www.wikieducator.org](http://www.wikieducator.org)

[www.wikieducator.org/user:Rima](http://www.wikieducator.org/user:Rima)

## Eraser Tool

**1. Use the rectangle tool to draw a house.**

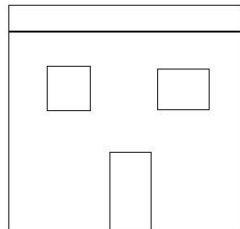

**2. Click the eraser tool in the toolbox.**

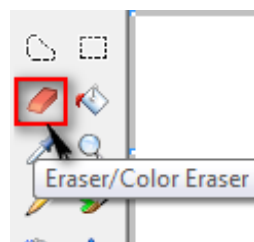

**3. Click the smallest erase size in the toolbox.**

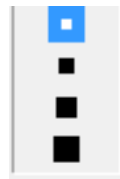

**4. Point to the right window then drag the mouse over the window it's erased.**

**5. Click the rectangle tool to draw the window again.**





## Using Air Brush Tool

1. Click the Airbrush tool in the toolbox.

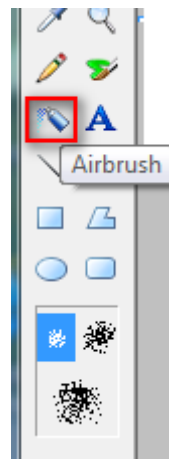

2. Place the Airbrush pointer on the canvas.
3. Click the mouse to spray a dot.
4. Click **brown** in the color box.
5. Drag the Airbrush pointer to draw a little line.
6. Use the Airbrush pointer to draw a tree that has a brown trunk and **green** leaves.

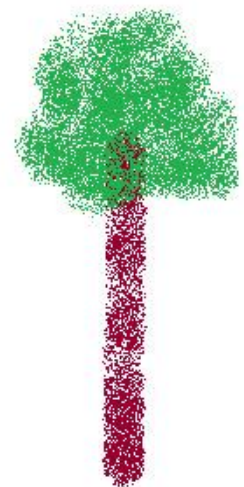



## Creating Shapes

1. Click the Rectangle tool in the toolbox.
2. Drag the Rectangle pointer down and away from the starting point on the canvas.
3. Click the Ellipse tool.
4. Drag the Ellipse pointer to draw a round shape.
5. The Rounded Rectangle tool draws shape with four sides that has rounded corners.
6. Click the Rounded Rectangle tool.
7. Point to the canvas where you want the shape to begin.

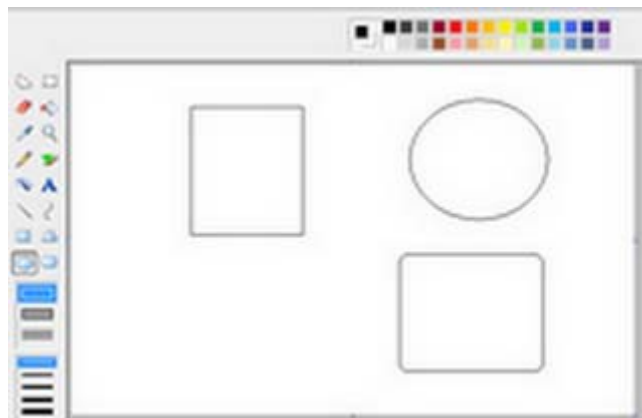
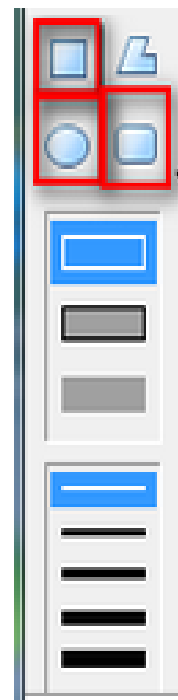



## Fill With Color Tool

1. Click the Fill With Color tool in the toolbox.

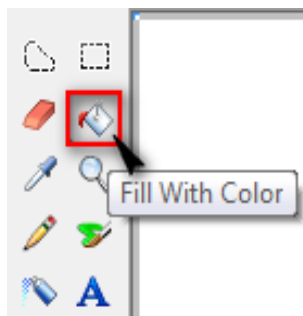

2. Click your favorite color in the color box.



3. Click inside one of the shapes. The shape fills with the color you picked from the color box.
4. Click inside each shape to fill each with a different color using the Fill with color tool.

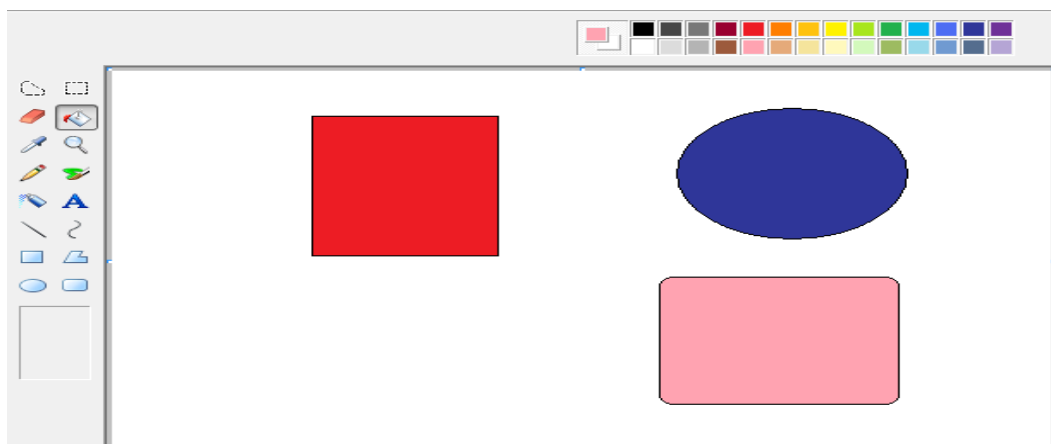



Aman Organization  
[www.amanyemen.org](http://www.amanyemen.org)



Wikieducator Organization  
[www.wikieducator.org](http://www.wikieducator.org)

[www.wikieducator.org/user:Rima](http://www.wikieducator.org/user:Rima)

## Line Tool

1. Click the Line tool in the toolbox and then click a line thickness in the toolbox.

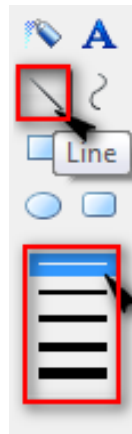

2. Drag the mouse pointer down to draw a straight line. Move the mouse pointer to a new place on the canvas then draw another line.
3. Draw a tic-tac-toe board and then draw the first X.

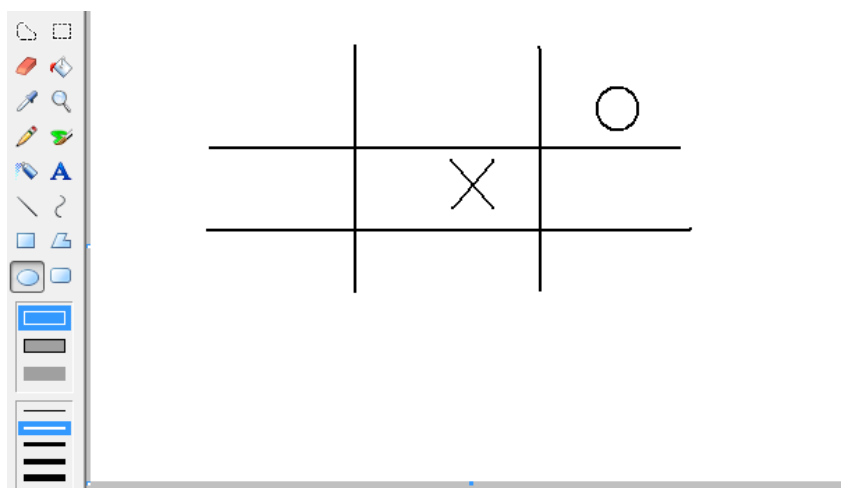



Aman Organization  
[www.amanyemen.org](http://www.amanyemen.org)



[www.wikieducator.org/user:Rima](http://www.wikieducator.org/user:Rima)

Wikieducator Organization  
[www.wikieducator.org](http://www.wikieducator.org)

## Text Tool

1. Draw a colorful picture using the draw tool.

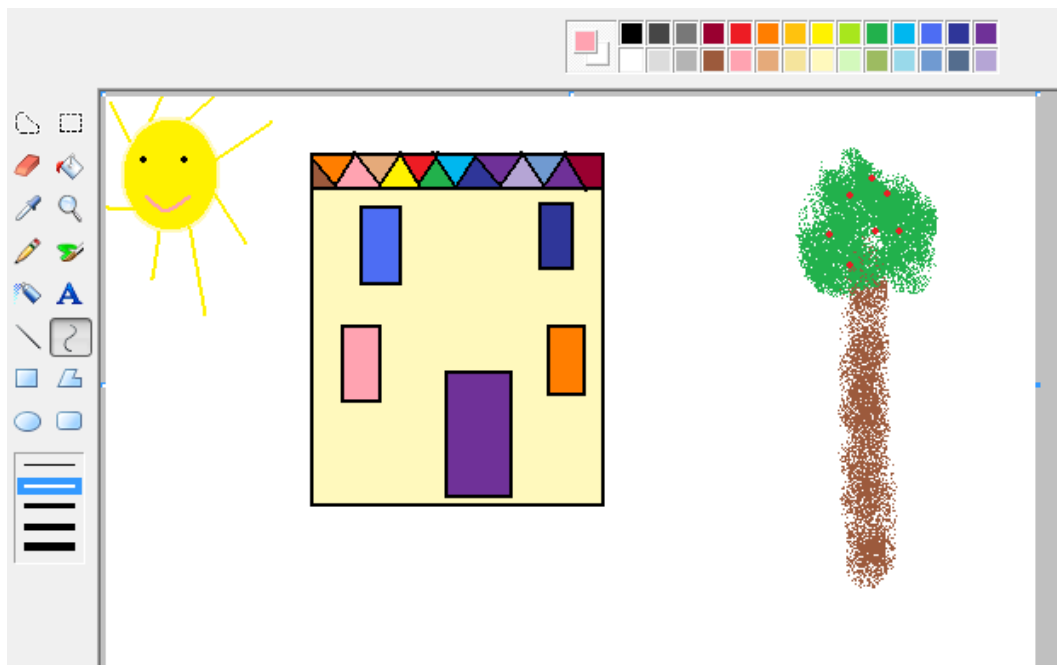

2. Click the Text tool in the tool box.





Aman Organization  
[www.amanyemen.org](http://www.amanyemen.org)



[www.wikieducator.org/user:Rima](http://www.wikieducator.org/user:Rima)

Wikieducator Organization  
[www.wikieducator.org](http://www.wikieducator.org)

3. Point to the white space near the bottom on the left side of your picture.
4. Drag the Text tool pointer to create a small box.
5. Use the keyboard to type your name in the box.

