

Basic trades for small island nations

Small Engine User Maintenance

Student workbook



THE COMMONWEALTH of LEARNING

Suite 1200
1055 West Hastings Street
Vancouver
BC V6E 2E9
CANADA
Telephone: 604 775 8200
Fax: 604 775 8210
<http://www.col.org>
email: info@col.org

THE OPEN POLYTECHNIC OF NEW ZEALAND

Wyndrum Avenue
Lower Hutt, New Zealand
Telephone 04 566 6189
Facsimile 04 566 5633
<http://www.topnz.ac.nz>
Private Bag 31914, Lower Hutt

This course is a part of the Pacific programme of Basic Trades training for small island nations. A programme initiated and supported by the Pacific Association for Technical and Vocational Education and Training (PATVET) and the Commonwealth of Learning.

Written and designed by Paul Wightman, The Open Polytechnic of New Zealand

Technical advice and editing: Doug Allen

Style and layout by The Open Polytechnic of New Zealand

Project managed by David Weston, The Open Polytechnic of New Zealand

Copyright © Commonwealth of Learning, 2006

Contents

Introduction to Student Workbook

What is this course for?

What does the course cover?

The role of your tutor

Modules

Introduction to small engines

How do engines work?

4-stroke engines

2-stroke engines

Measuring size and power

Things an engine needs to work

Air, fuel and sparks

Service and repair workshops

Information and manuals

Safety

General

Fuel safety

Air

Air cleaners and pipes

Filters

Maintenance

Fuel

Petrol

Grades

Petrol

Ratio and Mixing

Other fuels

Carburettor

- Filters
- Fuel tanks
- Primers
- Fuel lines
 - Fuel – maintenance

Electrics

- Introduction
- Magneto
- Timing
- Spark plugs
- Plug leads and caps
 - Ignition maintenance

Cooling

- Air cooled
- Water cooled
- Flushing outboards
 - Cooling – maintenance

Oil and grease

- Maintenance

Starters

- Replacing starter cord
- Outboard motor emergency start

Maintaining non-engine parts of your equipment

- Outboard motors
- Chainsaws
- Mowers

Fault finding

- Fault chart
- General condition checks

Tools and spare parts

Technical data for MY engine

Credits

The idea of a Basic Trades programme was originally proposed at the PATVET Institute in 2002 and then was explored and documented at a workshop held in Suva, Fiji in June 2003. This workshop involved ideas and input from representatives of mainly smaller island nations in PATVET:

Kiribati	Taeboa Tabanga
Nauru	Ande Dubuae
Niue	Charlie Tohovaka
Tuvalu	Lapana Ene
Fiji (FIT)	Joeaia Vinali and Viliame Ramici

Further input and validation of the material was gratefully received from:

Doug Allen
 Don Jeffery
 The Open Polytechnic of New Zealand – David Weston
 Fiji Institute of Technology, School of Engineering and Road Transport – Apisai Dovitana
 Tonga Institute of Science and Technology – Oto Misi

Thanks also to all the people of Tarawa, Tuvalu, Fiji and Samoa who contributed information or appear in this material.

Betio Hardware, Tarawa
 The Power Boat Centre, Seaview, Wellington, New Zealand for information and photographs.
 The Media Centre, NUS, National University of Samoa
 Mercury Marine, for input and use of their material

The following companies products have been used to illustrate or describe examples in this course material

AC	Denso	Shell
Autolite	Honda	Stihl
Bosch	Johnson	Suzuki
BP	Mercury	Techumseh
Briggs and Stratton	McCulloch	Valvoline
Caltex	Mobil	Victa
Castrol	NGK	Yamaha
Champion	Ryobi	

While these are all excellent products, COL does not endorse them as being available or especially suitable for any of the many and varied locations and situations of the intended use of this course.

What is this course for?

This course is a basic introduction to the simple operator maintenance of small engines.

It helps you to:

- Understand how engines work.
- Understand the major parts of an engine and what they do
- Stop engine problems happening
- Carry out basic servicing jobs
- Know your limits – what you should NOT try to do
- Find simple faults
- Use basic tools.

You will work with engines, materials and tools that are available locally.

The focus of this course is on outboard engines for small boats, but the theory and practical maintenance apply to most other small engines – such as mowers, brush-cutters, chain saws and generators.

The course is for school leavers and community groups who have limited knowledge or experience working on small engines.

When you have finished this course you should be able to work on simple engine maintenance on your own. You will still need to send more complex work to an experienced service mechanic.

What does the course cover?

Small engine user maintenance covers four main topics:

How small engines work

You learn about the basic 4-stroke and 2-stroke cycle engines and the types of equipment they power. The course concentrates on outboard motors. You find out what types of engines, parts and materials are available in your area and where to get them from.

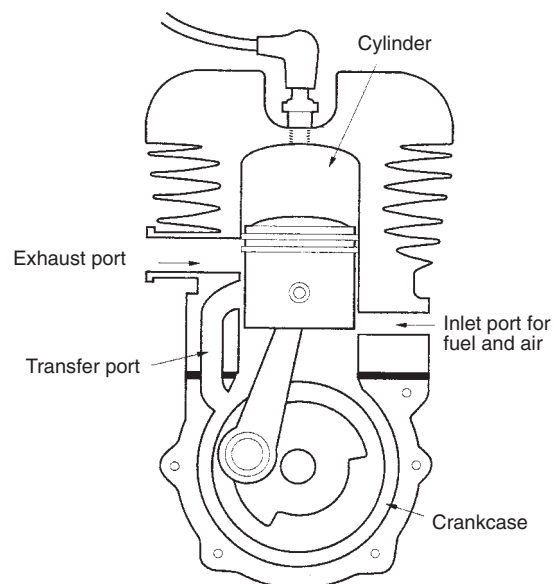

Major engine components - operation and maintenance

You learn about the main parts needed for an engine to run. You look at the different parts used for:

Air, fuel, electrics, cooling and oil.



You learn about the things you can do to help keep an engine trouble-free (preventative maintenance). You then practice servicing all the parts you should check, clean or replace on your own engine.

Maintaining the non-engine parts of your equipment



These are worksheets to help you maintain the things that your engine drives. Gear-boxes, controls, belts, chains. For example, the propeller and lower gear case of your outboard.

Fault finding

You follow logical steps in a guide to find the cause of basic engine faults.

Tools and spare parts

Suggestions for the tools and spare parts the students need to carry out operator maintenance. You will find out what service parts you need for *your engine* and where you can get them from.



Safety

This a checklist to remind you about safety at all times. Safety is also covered in each module.

How is the course put together?

The course is a basic introduction for people who know little about looking after a small engine.

The course **must** be led by a tutor or experienced trades person who can show you the steps, how to use tools correctly and guide you on developing your skills.

The course will work best with small groups of students who can talk about things and learn from each other.

Students' Workbook

This Workbook has exercises, pictures and explanations as well as space to make your own notes.

Your Workbook also has a copy of a Worksheet and an activity sheet for most of the big steps.

Your tutor will work through each worksheet with you, talking about the parts, tools and materials and showing you how to use them.

You should not use the worksheets to learn on your own, but they should make good notes for you to look back at later on.

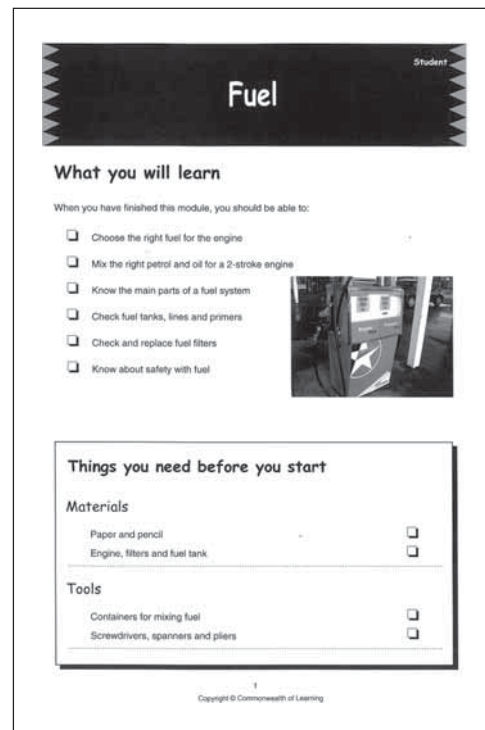

The role of the Tutor

Your tutor for this course is a competent tradesperson with knowledge of small engine mechanics. They will talk with you about different engines, how things work and then show you how to look after them.

Your tutor will:

- Have samples of engines, tools and equipment for you to work with
- Lead you through the course
- Explain the written material
- Show you what you should maintain on your engine
- Show you how to use tools correctly and safely
- Watch you work and tell you how you are doing.

Activities

During the course you will work on an engine to use the skills you have learned. If you have your own engine, you can work on that as well as practising on other types.

This course tells you a lot about engines, parts and adjustments, but you need to be able to do the maintenance and use the tools – not just talk about them.

The course books and your tutor can show you how to do things – but take plenty of time to practice in the activities.

Whenever you can, work with two or three students. You can

- watch and give each other feedback on how you are doing
- learn from watching them.

